

1400 Coliseum Blvd. 36110-2400 • Post Office Box 301463  
Montgomery, Alabama 36130-1463  
(334) 271-7700 • FAX (334) 271-7950

## **CATEGORICAL EXCLUSION FROM ENVIRONMENTAL REVIEW**

City of Selma Water Works & Sewer Board  
Dallas County

SRF Project No. CS010879-01

October 28, 2020

The Alabama Department of Environmental Management has made \$993,960 in financial assistance available to The City of Selma Water Works & Sewer Board using funds from the Clean Water State Revolving Fund (CWSRF) loan program. In accordance with State and Federal regulations that govern the program, the Alabama Department of Environmental Management has conducted a review to assess the potential impacts upon the environment that may result from implementation of this project.

The City of Selma Water Works & Sewer Board proposes complete replacement of Helen Street Pump Station along with the replacement of Trickling Filter Float Valves, the walls of ten (10) sludge drying beds, and replacement of pumps, piping and valves in pump station #3 at Valley Creek WWTP. Proposed improvements will ensure continued and effective wastewater collection and treatment service.

The Alabama Department of Environmental Management has determined that the project qualifies for a Categorical Exclusion (CE) from further environmental study under the guidelines specified by the State Environmental Review Process (SERP) which specifically include actions which are solely directed toward minor rehabilitation of existing facilities, functional replacement of equipment, or towards the construction of new ancillary facilities adjacent or appurtenant to existing facilities. However, this decision may be reconsidered if significant adverse information concerning the potential environmental impacts of the project is discovered.

Comments relative to this project should be submitted in writing to Juliette Waid, SRF Section, Permits & Services Division, Alabama Department of Environmental Management, P.O. Box 301463, Montgomery, Alabama 36130-1463, no later than 30 days after the date of public notice. The Alabama Department of Environmental Management will not take formal action to proceed with the project without carefully evaluating any public comments opposing the project.

Lance R. LeFleur  
Director

LRL/EJR/JMW/kmh

Attachment



City of Selma Water Works & Sewer Board  
SRF# CS010879-01

The Categorical Exclusion is promulgated in the State Environmental Review Process (SERP) in Part IV, Section B: Categorical Exclusions for Clean Water State Revolving Fund Projects: (Italicized sections apply.)

1. The following clean water projects are eligible for categorical exclusions.
  - a. *Actions which are solely directed toward minor rehabilitation of existing facilities, functional replacement of equipment, or towards the construction of new ancillary facilities adjacent or appurtenant to existing facilities;*
  - b. Actions which do not affect the degree of treatment or capacity of the existing facility including, but not limited to, infiltration and inflow corrections, replacement of existing mechanical equipment or structures, and the construction of small structures on existing sites;
  - c. Actions which are for minor upgrading and minor expansion of existing treatment works in sewerred communities with a population less than 10,000;
  - d. Actions where on-site technologies are proposed in unsewered communities of less than 10,000;
  - e. Construction of new wastewater collection systems for existing communities, only if ancillary or appurtenant to existing facilities;
  - f. Projects where funding is being provided for planning and/or engineering costs only (in which case the requirements of IV.B.1 a-f do not apply)
2. In order to determine if a clean water project is eligible for a CE, all of the following conditions must not apply:
  - a. The action is known or expected to have a significant effect on the quality of the human environment, either individually, cumulatively over time, or in conjunction with other federal, State, local, tribal or private actions.
  - b. The action is known or expected to adversely impact:
    - 1) Cultural resources areas such as archaeological and historical sites,
    - 2) Endangered or threatened species and their critical habitats,
    - 3) Environmentally important natural resources areas such as floodplains, wetlands, important farmlands, or aquifer recharging zones.
  - c. This action is known or expected not to be cost-effective or to cause significant public controversy.
  - d. The facilities to be provided will
    - 1) Create a new, or
    - 2) Significantly relocate an existing discharge to surface or ground waters.
  - e. The facilities will result in more than 30% increases in the volume of discharge or the loading of pollutants from an existing source or from new facilities to receiving waters.
  - f. The facilities would provide capacity to serve a population 30% higher than the anticipated design population.

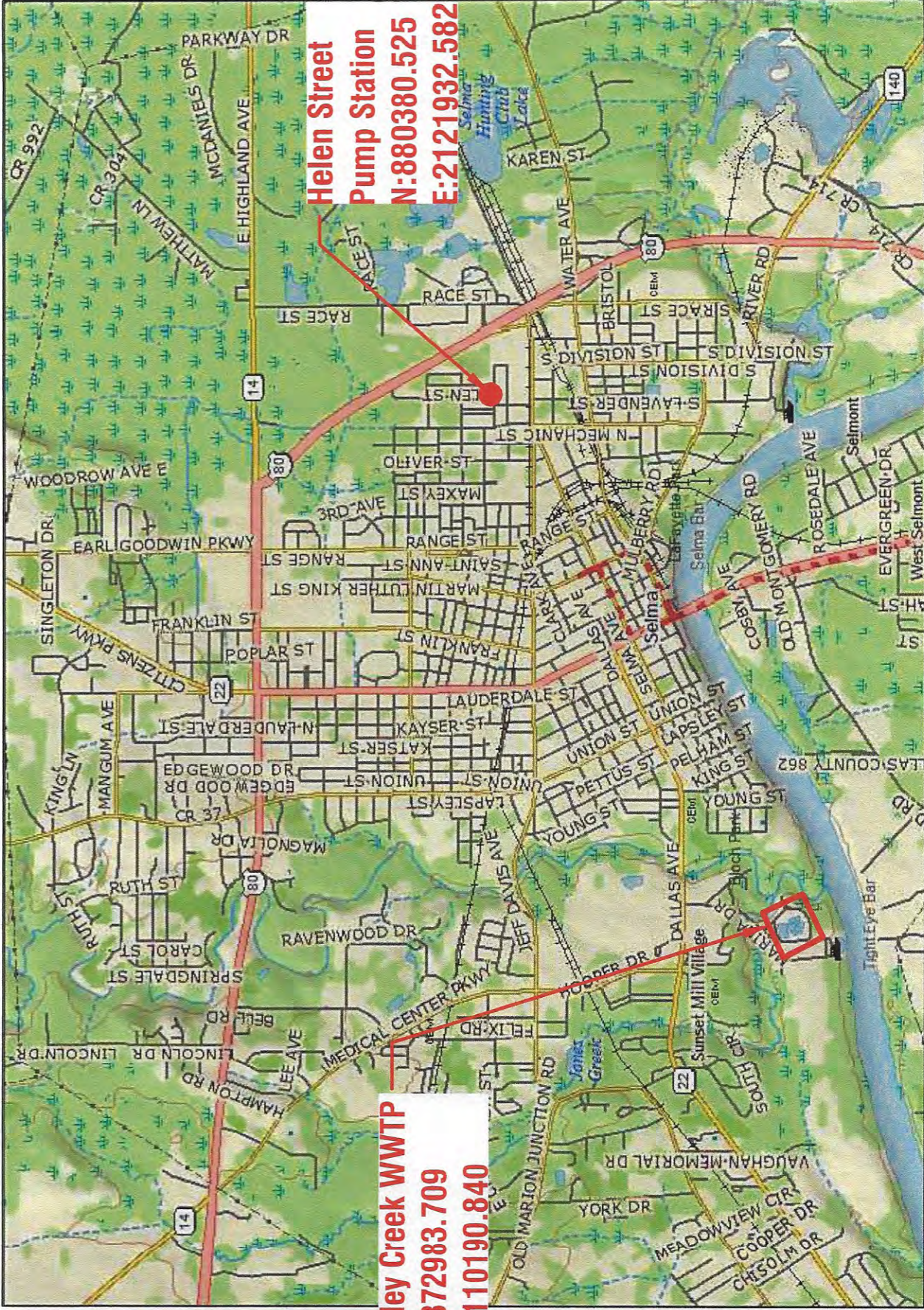

**Helen Street  
Pump Station  
N: 880380.525  
E: 2121932.582**

**Valley Creek WWTP  
N: 872983.709  
E: 2110190.840**

Selma Waterworks  
FY19 CWSRF Project  
May, 2020  
Project No. CS010879-01



# ALABAMA HISTORICAL COMMISSION

468 South Perry Street  
P.O. Box 300900  
Montgomery, Alabama 36130-0900  
334-242-3184 / Fax: 334-240-3477

Lisa D. Jones  
Executive Director  
State Historic Preservation Officer

July 20, 2020

D. Ray Hogg, Jr.  
1 Satterfield Street  
Selma, AL 36701

Re: AHC 20-1001  
Valley Creek WWTP Upgrades and Pump Station Replacements  
Dallas County

Dear Mr. Hogg:

Upon review of the above referenced project, we have determined that project activities will have no effect on cultural resources eligible for or listed on the National Register of Historic Places. Therefore, we concur with the proposed project activities.

Consultation with the State Historic Preservation Office does not constitute consultation with Tribal Historic Preservation Offices, other Native American tribes, local governments, or the public. If archaeological materials are encountered during construction, the procedures codified at 36 CFR 800.13(b) will apply. Archaeological materials consist of any items, fifty years old or older, which were made or used by man. These items include but are not limited to, stone projectile points (arrowheads), ceramic sherds, bricks, worked wood, bone and stone, metal, and glass objects. The federal agency or the applicant receiving federal assistance should contact our office immediately. If human remains are encountered, the provisions of the Alabama Burial Act (*Code of Alabama* 1975, §13A-7-23.1, as amended; Alabama Historical Commission Administrative Code Chapter 460-X-10 Burials) should be followed. This stipulation shall be placed on the construction plans to insure contractors are aware of it.

We appreciate your commitment to helping us preserve Alabama's historic archaeological and architectural resources. Should you have any questions, please contact Eric Sipes at 334.230.2667 or [Eric.Sipes@ahc.alabama.gov](mailto:Eric.Sipes@ahc.alabama.gov). Have the AHC tracking number referenced above available and include it with any future correspondence.

Sincerely,

A handwritten signature in blue ink that reads "Lee Anne Wofford".

Lee Anne Wofford  
Deputy State Historic Preservation Officer

LAW/EDS/law



HOGG STONE & ASSOCIATES ENGINEERS, INC.

TH/JG  
2020-TH-1022

1 Satterfield St  
Selma, AL 36701

O: 334.875.1960  
F: 334.875.1961

May 28, 2020

RECEIVED  
JUN 05 2020

BY: *CS*

U.S. Department of the Interior  
Fish and Wildlife Service  
1208-E Main Street  
Daphne, Alabama 36526

**RE: Water Works and Sewer Board of the City of Selma  
Clean Water State Revolving Fund Project No. CS 010879-01**

To whom it may concern:

The Water Works and Sewer Board of the City of Selma is proposing to submit a Clean Water State Revolving Fund Application to the State of Alabama Department of Environmental Management. Funds will be used to implement various improvements to the system's sanitary sewer system at various locations throughout the City. Work proposed under this project is as follows:

1. Replacement and relocation of Helen Street Pump Station
2. Replacement and relocation of Franklin Street Pump Station
3. Upgrades at the Valley Creek Wastewater Treatment Plant

The work included in this project will involve the relocation of the Helen Street Pump Station from under the edge of the pavement to an adjacent lot owned by the Selma Waterworks. Also, the work will include involve the relocation of the Franklin Street Pump Station from under the center of the street to an adjacent lot owned by the Selma Waterworks. The final part of this project will include improvements at the Valley Creek Wastewater Treatment Plant to include replacing of the Tricking Filter float valves, replacing of pumps in the No. 3 pump Station, and replacing of the drying bed walls. All of this work will be performed within the confines of the WWTP, which was completed in 1968. Attached is a USGS Quad Map showing locations of proposed improvements as well as photos of the Helen Street and Franklin Street pump stations.

As part of the Environmental Information Document (EID), we are hereby requesting concurrence on this project from your agency.

If you should have any questions, please do not hesitate to give me a call at (334) 875-1960 or email me at [hoggeng@bellsouth.net](mailto:hoggeng@bellsouth.net)

Sincerely,

**HSA ENGINEERS, INC.**

*D. Ray Hogg, Jr.*  
D. Ray Hogg, Jr., P.E.



U.S. Fish and Wildlife Service  
1208-B Main Street – Daphne, Alabama 36526  
Phone: 251-441-5181 Fax: 251-441-6222

No federally listed species/critical habitat are known to occur in the project area. As described, the project will have no significant impact on fish and wildlife resources. IF PROJECT DESIGN CHANGES ARE MADE, PLEASE SUBMIT NEW PLANS FOR REVIEW. We recommend use of best management practices specific to your project (See <http://www.fws.gov/daphne/section7/bmp.html> ).

CC: Hon. Darrio Melton  
Board Members  
Ms. Maxine Tarver

Digitally signed by WILLIAM PEARSON  
Date: 2020.06.18 14:36:39 -05'00' # 3



REPLY TO  
ATTENTION OF:

**DEPARTMENT OF THE ARMY  
CORPS OF ENGINEERS, MOBILE DISTRICT  
218 SUMMIT PARKWAY, SUITE 222  
HOMEWOOD, ALABAMA 35209**

June 16, 2020

North Branch  
Regulatory Division

SUBJECT: Department of the Army Jurisdictional Determination, File Number SAM-2020-00574-JLB, Water Works and Sewer Board of Selma – Sewer System Improvements

Water Works and Sewer Board of Selma  
c/o Hogg Stone and Associates Engineers, Inc.  
Attention: Mr. Ray Hogg  
1 Satterfield Street  
Selma, Alabama 36701

Transmitted electronically to [hoggeng@bellsouth.net](mailto:hoggeng@bellsouth.net)

Dear Mr. Hogg:

This is in response to your letter, on behalf of the Water Works and Sewer Board of Selma, dated May 28, 2020, requesting comments regarding the proposed construction of new pump stations on Helen Street (Latitude N32.419373, Longitude W87.002791) and Franklin Street (Latitude N32.408070, Longitude W87.017781) and improvements to the existing Valley Creek wastewater treatment facility (Latitude N32.399413, Longitude W87.041114). The work will occur in Selma, Dallas County, Alabama. This project has been assigned file number **SAM-2020-00574-JLB**, which should be referred to in all future correspondence regarding the project.

Based on our review of the information you provided and other publicly available mapping resources, we have determined the construction of new pump stations on Helen Street and Franklin Street and improvements to the Valley Creek wastewater treatment plant would occur on non-jurisdictional dry land or upland areas that do not contain Federally-regulated wetlands or other “waters of the United States (U.S.)”

The proposed work at the specific locations identified above was reviewed pursuant to Section 404 of the Clean Water Act, which requires that a DA permit be obtained for the placement or discharge of dredged and/or fill material into “waters of the United States”, including wetlands, prior to conducting the work (33 U.S.C. 1344). For regulatory purposes, the U.S. Army Corps of Engineers (USACE) defines wetlands as those areas that are inundated or saturated by surface or groundwater at a frequency and duration sufficient to support, and under normal circumstances do support, a prevalence of vegetation typically adapted for life in saturated soil conditions.

This letter contains approved jurisdictional determinations (JDs) for the three construction locations as specified above. If you object to this determination, you may request an administrative appeal under USACE Regulations at 33 CFR Part 331. Attached you will find a Notification of Appeal Process (NAP) fact sheet and Request for Appeal (RFA) form. If you request to appeal this determination you must submit a completed RFA form to the USACE, South Atlantic Division Office at the following address:

Administrative Appeals Review Officer  
Attention: Mr. Philip Shannin  
Telephone: (404) 562-5137, Fax: (404) 562-5138  
60 Forsyth Street Southwest, Room 10M15  
Atlanta, Georgia 30303-8801

In order for an RFA to be accepted by the USACE, the USACE must determine that it is complete, that it meets the criteria for appeal under 33 CFR Part 331.5, and that it has been received by the Division Office within 60 days of the date of the NAP. Should you decide to submit an RFA form, it must be received at the above address by August 17, 2020. It is not necessary to submit an RFA form to the Division Office if you do not object to the determination in this letter.

This approved JD is based on current policy and regulation and is valid for a period of five years from the date of this letter. If by the end of the five-year period the proposed work has not been implemented and this JD has not been specifically revalidated by the USACE, it shall automatically expire.

The statements contained herein do not convey any property rights or any exclusive privileges, and do not authorize any injury to property nor shall it be construed as excusing you from compliance with other Federal, State, or local statutes, ordinances, or regulations that may affect proposed work at this site. Furthermore, this determination has been conducted to identify the limits of the USACE Clean Water Act jurisdiction for the particular site identified in this request. This determination may not be valid for the wetland conservation provisions of the FSA of 1985, as amended. If you are a U.S. Department of Agriculture (USDA) program participant, or anticipate participation in USDA programs, you should request a certified wetland determination from the local office of the Natural Resources Conservation Service prior to starting work.

If you intend to sell property that is part of a project that requires DA authorization, it may be subject to the Interstate Land Sales Full Disclosure Act. The Property Report, required by Housing and Urban Development Regulation, must state whether or not a permit for the development has been applied for, issued or denied by the USACE, (Part 320.3(h) of Title 33 of the Code of Federal Regulations).

Based on our findings regarding the proposed work and construction activities at the locations specified herein, a DA permit pursuant to Section 404 of the Clean Water Act **will not be required** to implement the work proposed at these locations.

We appreciate your cooperation with the USACE Regulatory Program. If the locations or scopes of work change for the new sewer pump station sites or the improvements within the existing wastewater treatment plant, you are urged to contact this office for a verification of this determination.

You may contact the project manager, Mr. Logan Brown, at (205) 290-9096 or at [jacob.l.brown@usace.army.mil](mailto:jacob.l.brown@usace.army.mil), if you have questions concerning this matter. For additional information about our Regulatory Program, visit our website at [www.sam.usace.army.mil/Missions/Regulatory.aspx](http://www.sam.usace.army.mil/Missions/Regulatory.aspx). Also, while you are there please take a moment to complete our regulatory customer survey located near the bottom of the webpage. Your responses are appreciated and will help us improve our services.

Sincerely,

**TURNEY.LESLIE**  
**.E.1297552585**

Digitally signed by  
TURNEY.LESLIE.E.1297552585  
Date: 2020.06.16 09:49:59  
-05'00'

Leslie E. Turney, Chief  
North Branch  
Regulatory Division

Attachments



TO: Mr. Ray Hogg

DATE: August 12, 2020

FROM: Alabama-Tombigbee Regional Commission  
107 Broad Street  
Camden, Alabama 36726  
334-682-4234  
Fax: 334-682-4205

**PROJECT/PROGRAM: ADEM-SRF-Clean Water Project**

Project number CS 010879-01  
Total Project - \$993,960.00  
Project consists of upgrades at the Valley Creek WWTP and replacement of the Helen Street and Franklin Street Pump Stations.

**APPLICANT:**

The Water Works and Sewer Board of the City of Selma

This office has reviewed the above project/program. Our comments are indicated below. If you have questions, please contact the A-95 Review Officer at the Alabama-Tombigbee Regional Commission office listed above.

No Interest \_\_\_\_\_

Concur  X

Need More Data (see below) \_\_\_\_\_

Cannot Concur \_\_\_\_\_

Consistent with Regional Plans  X

Consistent with Local Plans \_\_\_\_\_

Additional Comments: \_\_\_\_\_

**ATRC**  
*Alabama-Tombigbee Regional Commission*

Signed: Frank B. Johnson  
A-95 Review Officer